

ISKRA LED

- **protection degree:** IP 66 for the optical part and driver
- **insulation class:** II
- **supply voltage:** 100-240 V AC, 50/60 Hz
- **light source:**
 - ISKRA LED ALFA 24 – CREE XT-E
 - ISKRA LED 24 – CREE XT-E
 - ISKRA LED ALFA 36 – CREE XP-L
 - ISKRA LED 36 – CREE XP-L
- **material:** anodised aluminum alloy
- **colour:** inox / black
- **installation:** ISKRA LED ALFA – directly on the column with spigot ending Ø60 mm length 80 mm
ISKRA LED – on extension arm with spigot ending Ø60 mm length 90 mm
- **recommended mounting height:** 4-5 m
- luminaire is adapter to work in temperatures between -40°C and +55°C

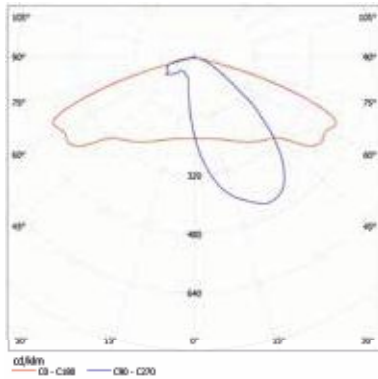

Light distribution curve for a luminaire ISKRA LED

Name	The colour temperature of light [K]	Code	Power / Number of LEDs [W / pcs.]	Total power [W]	Luminous flux [lm]*	Lighting efficiency [lm/W]	Weight [kg]	Current product card
ISKRA LED ALFA 24	5 000	213330/6	24/12	31	2 950	95	2,6	
	3 500	213330/3						
ISKRA LED ALFA 36	5 000	213332/6	36/12	39	4 700	121		
	3 500	213332/3			4 300	110		
ISKRA LED 24	5 000	213230/6	24/12	31	2 950	95	2,2	
	3 500	213230/3						
ISKRA LED 36	5 000	213232/6	36/12	39	4 700	121		
	3 500	213232/3			4 300	110		

* due to the LED precision class the tolerance value is +/- 7%



ISKRA LED

ISKRA LED ALFA

Luminaire ISKRA LED ALFA on column SAL DL – 10 height of 5 m



PARK LIGHTING/PARK LUMINAIRES

ISKRA LED

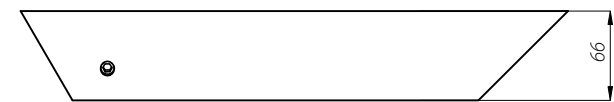
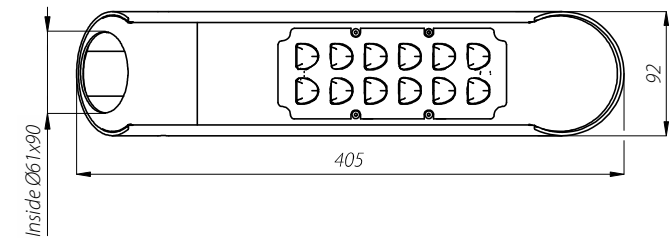

ISKRA LED

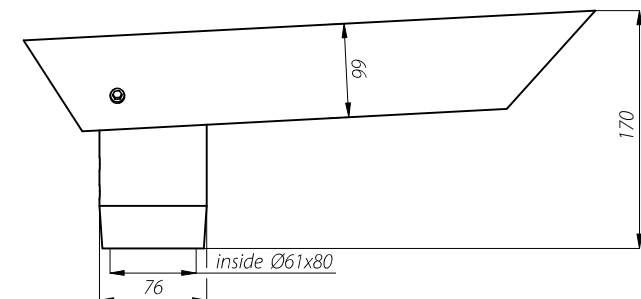
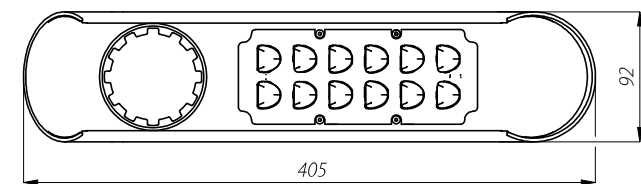

ISKRA LED ALFA

ISKRA LED FOR PEDESTRIAN CROSSING

- **protection degree:** IP 66 for the optical part and driver
- **insulation class:** II
- **supply voltage:** 100-240 V AC, 50/60 Hz
- **light source:**
 - ISKRA LED ALFA 36 – CREE XP-L
 - ISKRA LED 36 – CREE XP-L
- **material:** anodised aluminum alloy
- **colour:** inox / black
- **installation:** ISKRA LED ALFA – directly on the column with spigot ending Ø60 mm length 80 mm
ISKRA LED – on extension arm with spigot ending Ø60 mm length 90 mm
- **recommended mounting height:** 4-5 m
- luminaire is adapter to work in temperatures between -40°C and +55°C

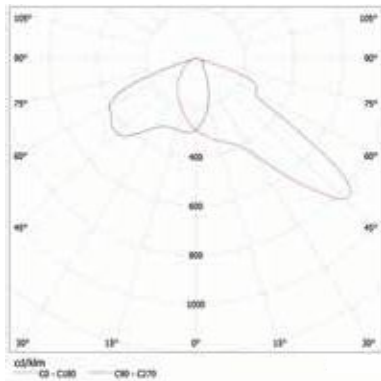

Light distribution curve for a luminaire ISKRA LED for pedestrian crossings with left-hand traffic

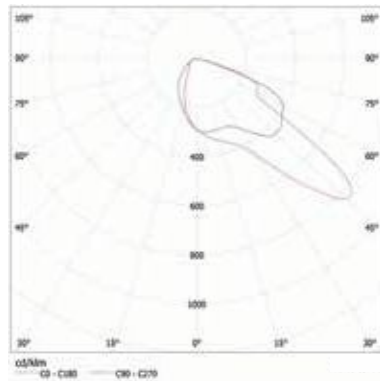

Light distribution curve for a luminaire ISKRA LED for pedestrian crossings with right-hand traffic



ISKRA LED FOR PEDESTRIAN CROSSINGS



ISKRA LED ALFA FOR PEDESTRIAN CROSSINGS

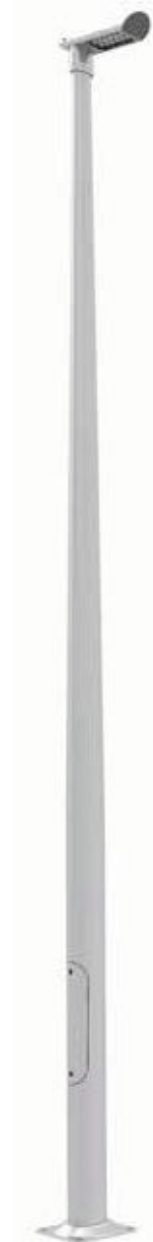

Luminaire ISKRA LED ALFA for pedestrian crossings on column SAL-4 height of 4 m

Name	The colour temperature of light [K]	Code	Power / Number of LEDs [W / pcs.]	Total power [W]	Luminous flux [lm]*	Lighting efficiency [lm/W]	Weight [kg]	Current product card
ISKRA LED P 36	5 000	2132032/6	36/12	39	4 700	121	5	
	3 500	2132032/3			4 300	110		
ISKRA LED P 36 ALFA	5 000	2130032/6	36/12	39	4 700	121	5	
	3 500	2130032/3			4 300	110		

* due to the LEDs precision class the tolerance value is +/- 7%



ISKRA LED FOR PEDESTRIAN CROSSING

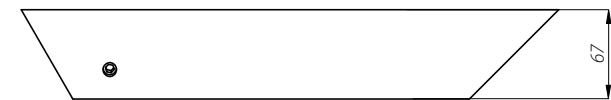
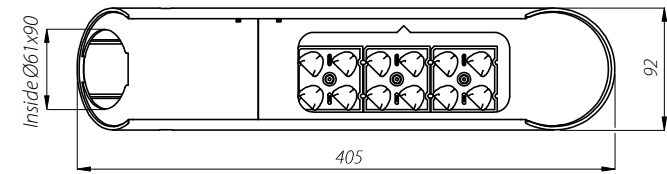

ISKRA LED FOR PEDESTRIAN CROSSINGS

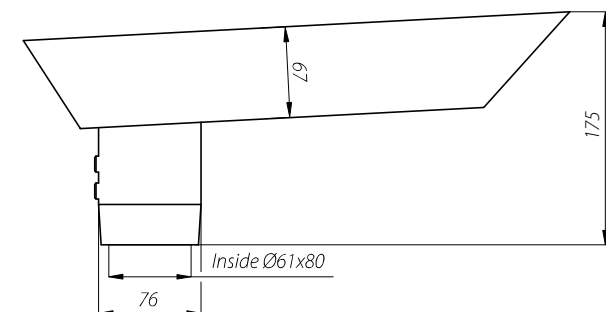
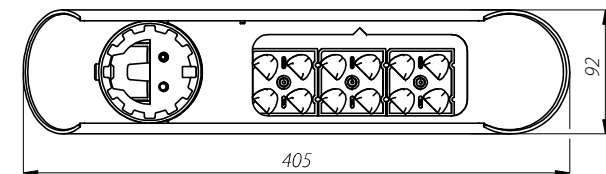

ISKRA LED ALFA FOR PEDESTRIAN CROSSINGS