

PARK LIGHTING / ALUMINIUM COLUMNS

STRAIGHT COLUMNS Ø 146

Columns with base plate

- SAL-60** code: 42313/C...
- SAL-50G** code: 42341/C...
- SAL-60G** code: 42343/C...

Rooted columns

- SAL-55 dz** code: 42322/C...
- SAL-60 dz** code: 42323/C...

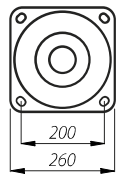
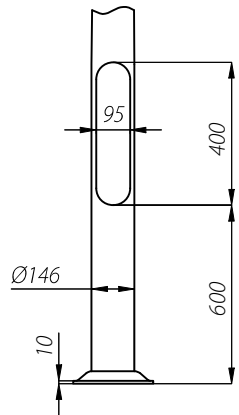

SAL-...G
B-51/Z-51

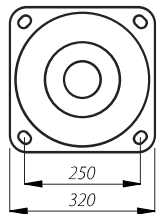

SAL-60
B-60/Z-60

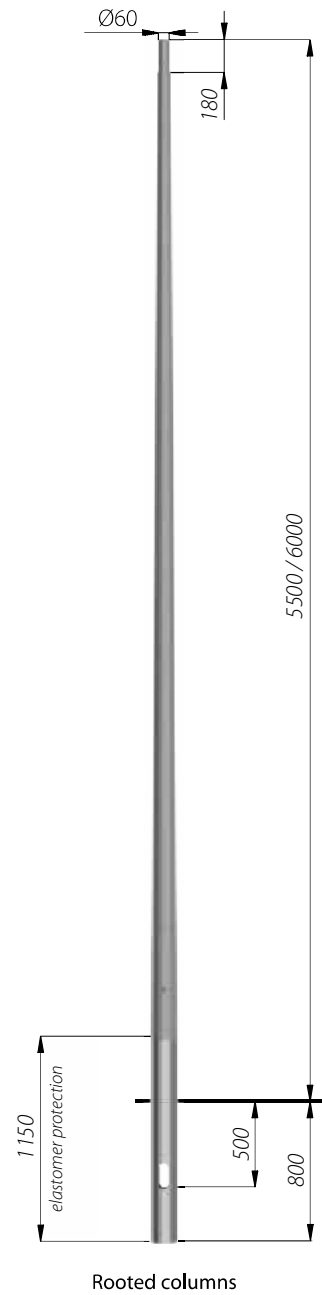
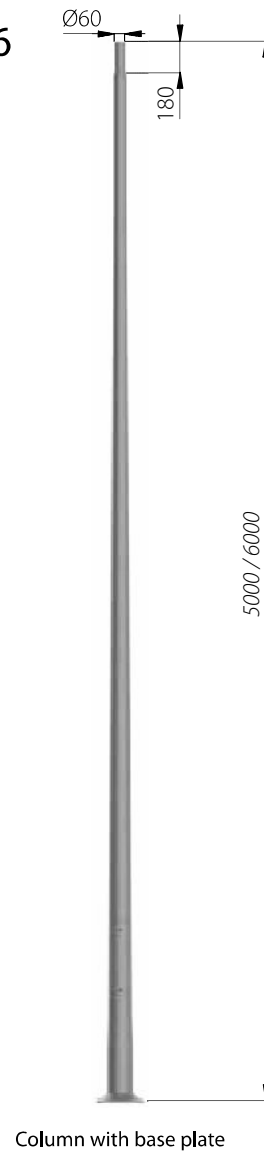

Sucha Beskidzka / Poland